

WM188F/P机组动力爆炸图

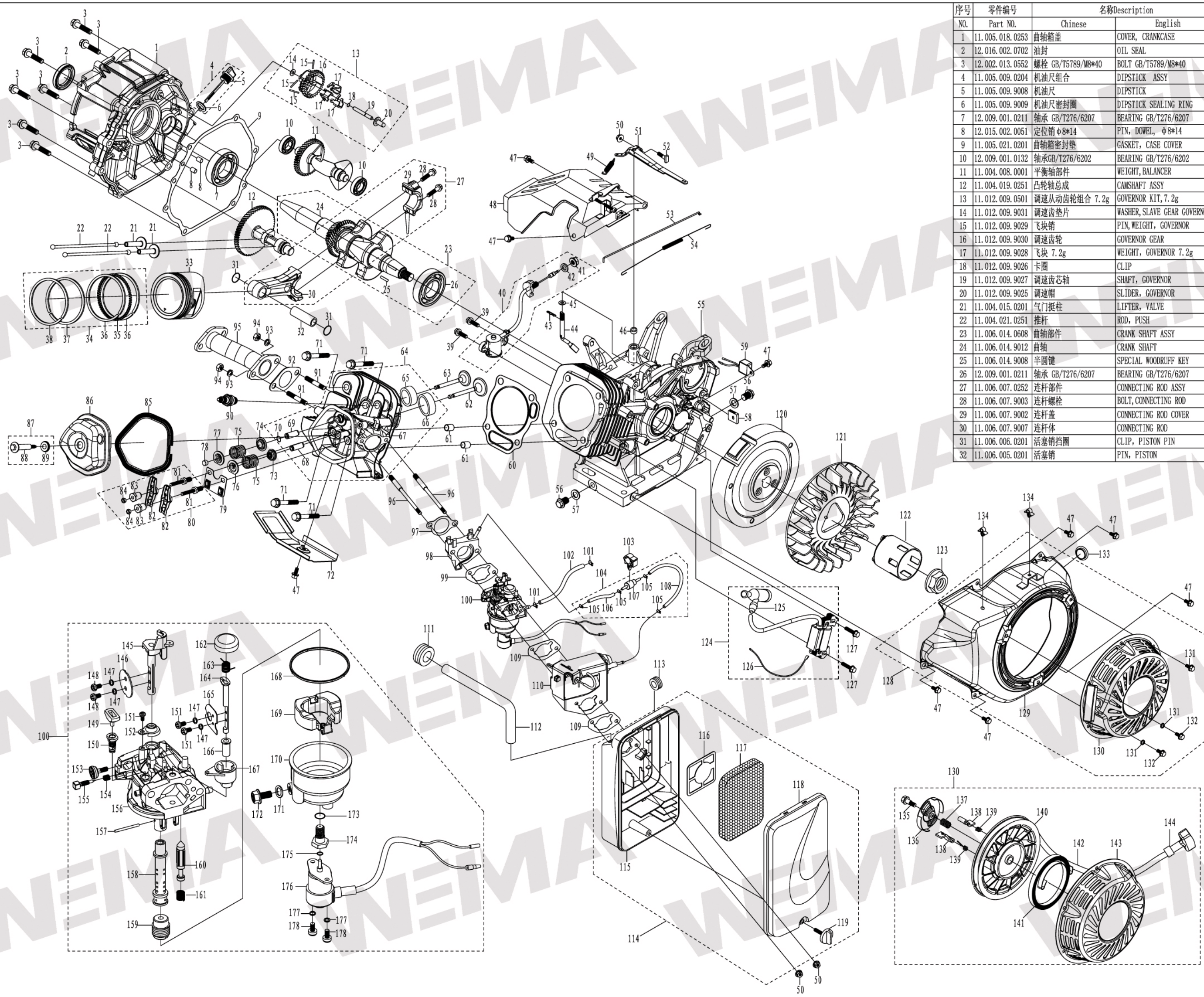

序号	零件编号	名称Description	数量	序号	零件编号	名称Description	数量	序号	零件编号	名称Description	数量
NO.	Part NO.	Chinese English	QTY.	NO.	Part NO.	Chinese English	QTY.	NO.	Part NO.	Chinese English	QTY.
1	11.005.018.0253	曲轴箱盖 COVER, CRANKCASE	1	33	11.006.003.0251	活塞 PISTON	1	106	11.001.021.9002	气管 φ4*φ8*79 PIPE φ4*φ8*79	1
2	12.016.002.0702	油封 OIL SEAL	2	34	11.006.004.0301	活塞环组合 PISTON RING ASSY	1	107	11.001.021.9001	单向阀 SINGLE-TRACK VALVE	1
3	12.002.013.0552	螺栓 GB/T5789/M8*40 BOLT GB/T5789/M8*40	7	35	11.006.004.9025	衬环 BUSH RING	1	108	11.001.021.9003	气管 φ4*φ8*130 PIPE φ4*φ8*130	1
4	11.005.009.0204	机油尺组合 DIPSTICK ASSY	1	36	11.006.004.9024	片环 FILM LOOP	1	109	11.001.012.0031	空滤器垫 GASKET, AIR CLEANER	2
5	11.005.009.9008	机油尺 DIPSTICK	1	37	11.006.004.9023	气环二 GAS RING TWO	1	110	11.001.018.0001	阻风门调节支架总成 ADJUSTING FRAME ASSY, CHOKE	1
6	11.005.009.9009	机油尺密封圈 DIPSTICK SEALING RING	1	38	11.006.004.9022	气环一 GAS RING ONE	1	111	11.001.016.9062	废气管胶卡圈 CLIP, WASTE GAS PIPE	1
7	12.009.001.0211	轴承 GB/T276/6207 BEARING GB/T276/6207	1	39	12.002.013.0160	螺栓 GB/T5789/M6*16 BOLT GB/T5789/M6*16	2	112	11.001.002.0201	废气管 WASTE GAS PIPE	1
8	12.015.002.0051	定位销 φ8*14 PIN, DOWEL, φ8*14	2	40	11.005.010.0151	机油传感器 OIL SENSOR	1	113	11.009.038.0001	油管胶卡圈 RUBBER CIRCLE, FUEL OIL PIPE	1
9	11.005.021.0201	曲轴箱密封垫 GASKET, CASE COVER	1	41	12.001.005.0057	螺母 GB/T66177 M10 NUT GB/T66177 M10	1	114	11.001.016.0201	空气滤清器部件 AIR CLEANER ASSY	1
10	12.009.001.0132	轴承 GB/T276/6202 BEARING GB/T276/6202	2	42	11.005.010.9001	密封圈 SEALING RING	1	115	11.001.016.9062	空滤器底座 AIR CLEANER CASE	1
11	11.004.008.0001	平衡轴部件 WEIGHT, BALANCER	1	43	11.012.004.0301	调速摆杆锁头 LOCKER, GOVERNOR ARM SHAFT	1	116	11.001.016.9065	滤芯挡板 PLATE, AIR CLEANER ELEMENT	1
12	11.004.019.0251	凸轮轴总成 CAMSHAFT ASSY	1	44	11.012.002.0401	调速摆杆 GOVERNOR ARM SHAFT	1	117	11.001.016.9064	滤芯 ELEMENT, AIR CLEANER	1
13	11.012.009.0501	调速从动齿轮组合 7.2g GOVERNOR KIT, 7.2g	1	45	12.006.014.0131	平垫圈 φ8*φ17*1 PLAIN WASHER φ8*φ17*1	1	118	11.001.016.9063	空气滤清器盖 COVER, AIR CLEANER	1
14	11.012.009.9031	调速齿垫片 WASHER, SLAVE GEAR GOVERNOR	1	46	11.012.005.0101	调速摆杆油封 φ8*φ14*5 OIL SEAL φ8*φ14*5	1	119	11.001.016.9053	空滤器螺栓 BOLT, AIR CLEANER	1
15	11.012.009.9029	飞块销 PIN, WEIGHT, GOVERNOR	1	47	12.002.013.0140	螺栓 GB/T5789/M6*12 BOLT GB/T5789/M6*12	8	120	11.008.007.0252	飞轮部件 FLYWHEEL	1
16	11.012.009.9030	调速齿轮 GOVERNOR GEAR	1	48	11.012.023.0504	油门操纵组合 THROTTLE CONTROL ASSY	1	121	11.010.012.0201	叶轮 FAN, COOLING	1
17	11.012.009.9028	飞块 7.2g WEIGHT, GOVERNOR 7.2g	1	49	11.012.010.0701	调速弹簧 GOVERNING SPRING	1	122	11.007.006.0201	自动杯 PULLEY, STARTER	1
18	11.012.009.9026	卡圈 CLIP	1	50	12.001.005.0020	螺母 GB/T6177/M6 NUT GB/T6177/M6	1	123	12.001.005.0090	螺母 GB/T6177/M16*1.5 NUT GB/T6177/M16*1.5	1
19	11.012.009.9027	调速齿轴 SHAFT, GOVERNOR	1	51	11.012.013.0501	调速支架 (臂) ARM, GOVERNOR	1	124	11.008.004.0151	点火器部件 IGNITION	1
20	11.012.009.9025	调速槽 SLIDER, GOVERNOR	1	52	12.002.005.0030	T型螺栓 T-SHAPE BOLT	1	125	11.008.004.9001	火花帽 CAP, IGNITION	1
21	11.004.015.0201	气门挺柱 LIFTER, VALVE	2	53	11.012.018.0401	拉杆 TIE ROD	1	126	11.008.004.9002	德火线 CORD, STOP SWITCH	1
22	11.004.021.0251	推杆 ROD, PUSH	2	54	11.012.020.0401	微调弹簧 FINE ADJUSTMENT SPRING	1	127	12.002.013.0190	螺栓 GB/T5789/M6*25 BOLT GB/T5789/M6*25	2
23	11.006.014.0608	曲轴部件 CRANK SHAFT ASSY	1	55	11.005.022.0304	曲轴箱体 CRANKCASE COMP	1	128	11.007.009.1137	启动器总成 RECOIL STARTER ASSY	1
24	11.006.014.0012	曲轴 CRANK SHAFT	1	56	12.002.012.0012	放油螺栓 GB/T16674/M12*1.5*15 BOLT, DRAIN PLUG GB/T16674/M12*1.5*15	2	129	11.007.009.9039	导风罩 FAN COVER	1
25	11.006.014.9008	半圆键 SPECIAL WOODRUFF KEY	1	57	12.006.014.0312	平垫圈 GB/T97/φ12*φ18*2 PLAIN WASHER GB/T97/φ12*φ18*2	2	130	11.007.008.0802	启动拉盘组合 STARTER COMP, RECOIL	1
26	12.009.001.0211	轴承 GB/T276/6207 BEARING GB/T276/6207	1	58	11.005.020.0001	曲轴箱胶圈 RUBBER RING, CRANKCASE	1	131	12.006.009.0001	平垫圈 GB/T95 φ6 WASHER φ6	3
27	11.006.007.0252	连杆部件 CONNECTING ROD ASSY	1	59	11.008.003.0001	单向导通器 BREAKER, PROTECTIVE	1	132	12.002.012.0121	螺栓 GB/T16674.1/M6*10 BOLT GB/T16674.1/M6*10	3
28	11.006.007.9003	连杆螺栓 BOLT, CONNECTING ROD	2	60	11.003.014.0301	汽缸头垫 GASKET, CYLINDER HEAD	1	133	11.007.009.9030	启动器堵头 PLUG, RECOIL STARTER	1
29	11.006.007.9002	连杆盖 CONNECTING ROD COVER	1	61	12.015.002.0110	定位销 φ12*20 PIN, DOWEL, φ12*20	2	134	11.005.027.0101	燕子线夹 CLIP	2
30	11.006.007.9007	连杆体 CONNECTING ROD	1	62	11.004.002.0251	进气门 VALVE, INLET	1	135	11.007.009.9027	中心螺栓 CENTER POSITION BOLT	1
31	11.006.006.0201	活塞销挡圈 CLIP, PISTON PIN	2	63	11.004.004.0251	排气门 VALVE, EXHAUST	1	136	11.007.009.9026	棘爪导板 RATCHET, GUIDE	1
32	11.006.005.0201	活塞销 PIN, PISTON	1	64	11.003.017.0201	汽缸头组合 CYLINDER HEAD ASSY	1	137	11.007.009.9025	中心弹簧 CENTER POSITION SPRING	1
65	11.003.017.9006	排气门座圈 VALVE SEAT, EX	1	138	11.007.009.9024	拉盘棘爪 RATCHET, STARTER	2	139	11.007.009.9023	棘爪回位扭簧 RETURN SPRING, RATCHET	2
66	11.003.017.9005	进气门座圈 VALVE SEAT, IN	1	140	11.007.009.9019	启动器卷簧 SPRING, STARTER RETURN	1	141	11.007.009.9021	启动器卷簧 SPRING, STARTER RETURN	1
67	11.003.017.9008	汽缸头 CYLINDER HEAD	1	141	11.007.009.9019	启动器卷簧 SPRING, STARTER RETURN	1	142	11.007.009.9010	拉绳 ROPE, RECOIL STARTER	1
68	11.003.017.9003	进气门导管 GUIDE, IN. VALVE	1	142	11.007.009.9010	拉绳 ROPE, RECOIL STARTER	1	143	11.007.009.9020	拉盘外壳 STARTER COVER COMP, RECOIL	1
69	11.003.017.9004	排气门导管 GUIDE, EX. VALVE	1	143	11.007.009.9020	拉盘外壳 STARTER COVER COMP, RECOIL	1	144	11.007.009.9029	拉绳手柄 HANDLE, STARTER	1
70	11.003.017.9007	气门导管卡圈 CLIP, VALVE GUIDE	1	144	11.007.009.9029	拉绳手柄 HANDLE, STARTER	1	145	11.009.006.9003	节气门轴 THROTTLE VALVE PIN	1
71	12.002.013.0720	螺栓 GB/T5789/M10*80 BOLT GB/T5789/M10*80	4	145	11.009.006.9003	节气门轴 THROTTLE VALVE PIN	1	146	11.009.006.9004	节气门板 THROTTLE VALVE BLOCK	1
72	11.010.001.0251	挡风罩 WINDSHIELD	1	146	11.009.006.9004	节气门板 THROTTLE VALVE BLOCK	1	147	11.009.006.9005	弹簧垫圈 GB/T93 3 SPRING WASHER GB/T93 3	4
73	11.004.001.0101	挡油罩 VALVE SEAL	1	147	11.009.006.9005	弹簧垫圈 GB/T93 3 SPRING WASHER GB/T93 3	4	148	11.009.006.9006	螺钉 M3*6 SCREW M3*6	2
74	11.004.011.0001	气门弹簧下座 BELOW SEAT OF VALVE SPRING	1	148	11.009.006.9006	螺钉 M3*6 SCREW M3*6	2	149	11.009.006.9008	怠速量孔压帽 CAP, IDLE HOLE	1
75	11.004.009.0151	气门弹簧 SPRING, VALVE	2	149	11.009.006.9008	怠速量孔压帽 CAP, IDLE HOLE	1	150	11.009.006.9009	怠速量孔组件 IDLE HOLE COMPONENT	1
76	11.004.003.0151	进气门弹簧座 INTAKE VALVE SPRING SEAT	1	150	11.009.006.9009	怠速量孔组件 IDLE HOLE COMPONENT	1	151	11.009.006.9101	螺钉 GB/T823 M3*6 SCREW GB/T823 M3*6	3
77	11.004.005.0151	排气门弹簧座 EXHAUST VALVE SPRING SEAT	1	151	11.009.006.9101	螺钉 GB/T823 M3*6 SCREW GB/T823 M3*6	3	152	11.009.006.9100	节气门防尘帽 COVER, THROTTLE VALVE	1
78	11.004.006.0101	排气门调节帽 ADJUSTER, EX. VALVE	1	152	11.009.006.9100	节气门防尘帽 COVER, THROTTLE VALVE	1	153	11.009.006.9007	怠速限位螺钉 JET SET, PILOT	1
79	11.004.022.0052	推杆支架 PLATE, PUSH ROD GUIDE	1	153	11.009.006.9007	怠速限位螺钉 JET SET, PILOT	1	154	11.009.006.9008	混合比调节螺钉弹簧 SCREW SET, PILOT	1
80	11.004.017.0101	气门摇臂组合 ARM ASSY, VALVE ROCKER	2	154	11.009.006.9008	混合比调节螺钉弹簧 SCREW SET, PILOT	1	155	11.009.006.9009	混合比调节螺钉 SCREW SET, PILOT	1
81	11.004.017.9006	气门摇臂定位螺栓 BOLT, PIVOT	2	155	11.009.006.9009	混合比调节螺钉 SCREW SET, PILOT	1	156	11.009.006.9004	化油器本体 CARBURETOR MIXTURE CHAMBER BODY	1
82	11.004.017.9005	气门摇臂 ARM, VALVE ROCKER	2	156	11.009.006.9004	化油器本体 CARBURETOR MIXTURE CHAMBER BODY	1	157	11.009.006.9021	浮子销 PIN, FLOAT SET	1
83	11.004.017.9003	气门摇臂调节螺母 ADJUSTING NUT, VALVE	2	157	11.009.006.9021	浮子销 PIN, FLOAT SET	1	158	11.009.006.9005	主喷管 NOZZLE, MAIN	1
84	11.004.017.9004	气门摇臂锁紧螺母 NUT, PIVOT LOCKING	2	158	11.009.006.9005	主喷管 NOZZLE, MAIN	1	159	11.009.006.9006	主量管 JET, MAIN	1
85	11.003.016.0303	汽缸头盖密封垫 GASKET, CYLINDER HEAD COVER	1	159	11.009.006.9006	主量管 JET, MAIN	1	160	11.009.006.9024	针阀 NEEDLE VALVE	1
86	11.003.017.0201	汽缸头盖组合 CYLINDER HEAD COVER COMP.	1	160	11.009.006.9024	针阀 NEEDLE VALVE	1	161	11.009.006.9025	弹簧 SPRING	1
87	11.003.027.0001	汽缸头盖螺栓组合 CYLINDER HEAD BOLT COMP.	1	161	11.009.006.9025	弹簧 SPRING	1	162	11.009.006.9102	阻风门防尘帽 COVER, CHOKE VALVE	1
88	11.003.027.9001	汽缸头盖螺栓 BOLT, CYLINDER HEAD COVER	1	162	11.009.006.9102	阻风门防尘帽 COVER, CHOKE VALVE	1	163	11.009.006.9103	阻风门回位扭簧 SPRING, CHOKE VALVE RETURN	1
89	11.003.027.9002	汽缸头盖螺栓密封圈 WASHER, CYLINDER HEAD COVER BOLT	1	163	11.009.006.9103	阻风门回位扭簧 SPRING, CHOKE VALVE RETURN	1	164	11.009.006.9104	阻风门轴 CHOKE VALVE PIN	1
90	11.008.009.0051	火花塞 F7TC SPARK PLUG F7TC	1	164	11.009.006.9104	阻风门轴 CHOKE VALVE PIN	1	165	11.009.006.9105	阻风门板 CHOKE VALVE BLOCK	1
91	12.015.026.0001	排气双头螺栓 M8*35 BOLT, STUD, M8*35	1	165	11.009.006.9105	阻风门板 CHOKE VALVE BLOCK	1	166	11.009.006.9106	衬套 LINING	1
92	11.002.004.0102	排气口垫 AIR EXHAUST WASHER	1	166	11.009.006.9106	衬套 LINING	1	167	11.009.006.9107	阻风门臂 ARM, CHOKE VALVE	1
93	12.006.008.0030	弹簧垫圈 GB/T93 8 SPRING WASHER GB/T93 8	2	167	11.009.006.9107	阻风门臂 ARM, CHOKE VALVE	1	168	11.009.006.9029	浮子室密封圈 WASHER	1
94	12.001.001.0020	1型六角螺母 GB/T6170/M8 NUT GB/T6170/M8	2	168	11.009.006.9029	浮子室密封圈 WASHER	1	169	11.009.006.9028	浮子室 CHAMBER SET, FLOAT	1
95	11.002.001.0202	排气管 EXHAUST PIPE	1	169	11.009.006.9028	浮子室 CHAMBER SET, FLOAT	1	170	11.009.006.9097	浮子室 CHAMBER SET, FLOAT	1
96	12.015.025.0361	进气双头螺栓 M6-8*110 BOLT, AIR INTAKE STUD, M6-8*110	2	170	11.009.006.9097	浮子室 CHAMBER SET, FLOAT	1	171	11.009.006.9031	密封垫 GASKET	1
97	11.001.009.0051	进气口垫 AIR INTAKE WASHER	1	171	11.009.006.9031	密封垫 GASKET	1	172	11.009.006.9032	放油螺栓 BOLT, DRAIN PLUG	1
98	11.001.004.0071	隔热板 INSULATOR PLATE	1	172	11.009.006.9032	放油螺栓 BOLT, DRAIN PLUG	1	173	11.009.006.9108	密封圈 GASKET	1
99	11.001.005.0051	化油器垫 PACKING, CARBURETOR	1	173	11.009.006.9108	密封圈 GASKET	1	174	11.009.006.9109	浮子室连接螺栓 CONNECTING BOLT	1
100	11.009.006.0305	化油器总成 CARBURETOR ASSY	1	174	11.009.006.9109	浮子室连接螺栓 CONNECTING BOLT	1	175	11.009.006.9110	密封圈 GASKET	1
101	11.009.023.0001	油管夹 FUEL TUBE CLAMP	2	175	11.009.006.9110	密封圈 GASKET					